

INNOVATION AND SPORTS CAMPUS

Damascus Road, PO Box 17-5208 Mar Mikhael, Beirut 1104 2020

☎ +961 (1) 421 000 ext. 6601 ✉ cis@usj.edu.lb

Administrator: Wassim SELWAN

INSTITUTIONS

Faculty of Economics

Dean: Jean-François VERNE | ☎ +961 (1) 421644 ✉ fse@usj.edu.lb

✉ jean-françois.verne@usj.edu.lb 🌐 www.usj.edu.lb/fse

Center for Economic Research and Documentation

Director: Loubna Al Saghir OUEIDAT - ext. 6755 ✉ cde-fse@usj.edu.lb

Faculty of Medicine

Higher Institute of Speech and Language Therapy

Director: Guillemette HENRY | ☎ +961 (1) 421 639 ✉ iso@usj.edu.lb

✉ guillemette.henry@usj.edu.lb

Institute of Psychomotor Therapy

Director: Celeste YOUNES HARB | ☎ +961 (1) 421616

✉ fm.ipm@usj.edu.lb ✉ celeste.younes@usj.edu.lb

Institute of Occupational Therapy

Director: Carla MATTA ABI ZEID | ☎ +961 (1) 421 662 ✉ iet@usj.edu.lb

✉ carla.abizeid@usj.edu.lb

HEALTH TECHNOLOGY POLE

Director: Roger LTEIF | ☎ 961 (1) 421000 ext. 6682 ✉ roger.lteif@usj.edu.lb

🌐 www.pts.usj.edu.lb

Laboratory of Pathogens

Director: Marianne ABI FADEL | ☎ +961 (1) 421000 ext. 6685/6691/6713

✉ marianne.abifadel@usj.edu.lb

Laboratory of Microbiology Quality Control

Director: Marianne ABI FADEL | ✉ marianne.abifadel@usj.edu.lb

Quality Control Supervisor: ☎ May MALLAH 961 (1) 421000 ext. 6691/6713

Rodolphe Mérieux Laboratory – Lebanon

☎ + 961 (1) 421 000 ext. 6679/ 6769 ✉ lrm-liban@usj.edu.lb

- Director of the Rodolphe Mérieux – Lebanon platform: Marianne ABI FADEL



- Biologist – Manager of the LRM - Lebanon: Marianne ANTAR - ext. 6769

✉ marianne.antar@usj.edu.lb

- Quality Assurance Supervisor, Biosecurity Officer, Laboratory Technician: Danielle CHAAYA - ext. 6679

✉ danielle.chaaya@usj.edu.lb

Laboratory of Biochemistry and Molecular Therapies

Director: Marianne ABI FADEL | ☎ +961 (1) 421000 - ext. 6687/6790

✉ marianne.abifadel@usj.edu.lb

Laboratory of Cranio-Facial Research

Director: Joseph BOU SERHAL | ☎ +961 (1) 421000 - ext. 2281/6782

✉ joseph.bouserhal@usj.edu.lb

Laboratory of Biomechanics and Medical Imaging

Director: Ayman ASSI | ☎ +961 (1) 421000 - ext. 6676/6770 ✉ ayman.assi@usj.edu.lb

Laboratory of Pharmacology, Clinical Pharmacy and Drug Quality Control

Director: Marianne ABI FADEL | +961 (1) 421000 - ext. 6687/6790 ✉ marianne.abifadel@usj.edu.lb

Head Laboratory Assistant: Fabienne HAJJ MOUSSA | ☎ +961 (1) 421000 - ext. 2170 ✉ fabienne.hajjmoussa@usj.edu.lb

Laboratory of Human Nutrition

Director: Khalil HELOU - ext. 6794 | ☎ +961 (1) 421000 - ext. 2188/6799

✉ khalil.helou@usj.edu.lb

Center Jacques Loiselet for Medical Genetics and Genomics

Director: Nassim FARES | ☎ +961 (1) 421000 - ext. 6633/6630/6636

✉ nassim.fares@usj.edu.lb ✉ cggm@usj.edu.lb

Laboratory of Research in Physiology and Physiopathology

Director: Nassim FARES | ☎ +961 (1) 421000 - ext. 6772 ✉ nassim.fares@usj.edu.lb

Laboratory of Metrology and Isotopic Fractionation

Director: Toufic RIZK | ☎ +961 (1) 421000 - ext. 1103 ✉ toufic.rizk@usj.edu.lb

Technical Director: Joseph BEJJANI | ✉ joseph.bejjani@usj.edu.lb

Laboratory of Neuroscience Research

Director: Joseph MAARAWI | ☎ +961 (1) 421000 - ext. 6678 ✉ joseph.maarawi@usj.edu.lb

Laboratory of Oncology and Carcinogenic Agents

Director: Jad CHEMALI | ☎ +961 (1) 421000 - ext. 6820 ✉ jad.chemali@usj.edu.lb



CARE CENTERS

Center for Diagnosis, Therapy and Research in Speech and Language Therapy

Director: Christel SALIBY | ☎ +961 (1) 421 641 ✉ iso@usj.edu.lb

Center for Diagnosis, Therapy and Research in Psychomotor Therapy

Director: Celeste YOUNES HARB | ☎ + 961 (1) 421616 ✉ celeste.younes@usj.edu.lb

✉ cdsipm@usj.edu.lb

LIBRARY

Innovation and Sports Library

Head Librarian: Jeanette RIZK - ext. 6715 ✉ biblio.cis@usj.edu.lb

🌐 www.biblio.usj.edu.lb 📞 : Bibliothèque - USJ

USJ DAYCARE

Director: Mirna OSSEIRAN | ☎ + 961 (1) 421680 ✉ mirna.osseiran@usj.edu.lb

SERVICES DU RECTORAT

Sports Office

Director: Maroun EL KHOURY | ☎ +961 (1) 421 623

✉ sports@usj.edu.lb 🌐 www.usj.edu.lb/sport

Financial Aid Office

Social worker: Carmen FAYAD EL HAYECK - ext. 1191 ✉ carmen.fayad@usj.edu.lb

📍 Rectorate, Berytech Building, 2nd floor

Information Technology Office

Director: Georges NAKHLÉ | ☎ ext. 1126 | ✉ sti@usj.edu.lb

Elie SLEIMAN - ext. 6787 (7h30-16h00) ✉ elie.sleiman@usj.edu.lb

☎ Helpdesk - ext. 6666 (7:30 am – 7:30 pm) 📍 Building C, 1st floor

Publications and Communication Office

Director: Christine OMEIRA WAZEN | ☎ +961 (1) 421 106 ✉ spcom@usj.edu.lb



MISCELLANEOUS

François S. Bassil Auditorium

Contact: Hala AFIF | ☎ + 961 (1) 421 602 ✉ cis@usj.edu.lb

Parking

(Managed by *Liban Park*)

Supervisor: Khaled ABBAS - ext. 6620 ✉ info@libanpark.com

MIM Museum

Director: Suzy HAKIMIAN - ext. 6670 ✉ suzy.hakimian@mim.museum

Recherche et Développement SARL

President: Fadi GEARA

Director: Joseph TANNOUS | ☎ + 961 (1) 421 659 ✉ joseph.tannous@usj.edu.lb



MAP

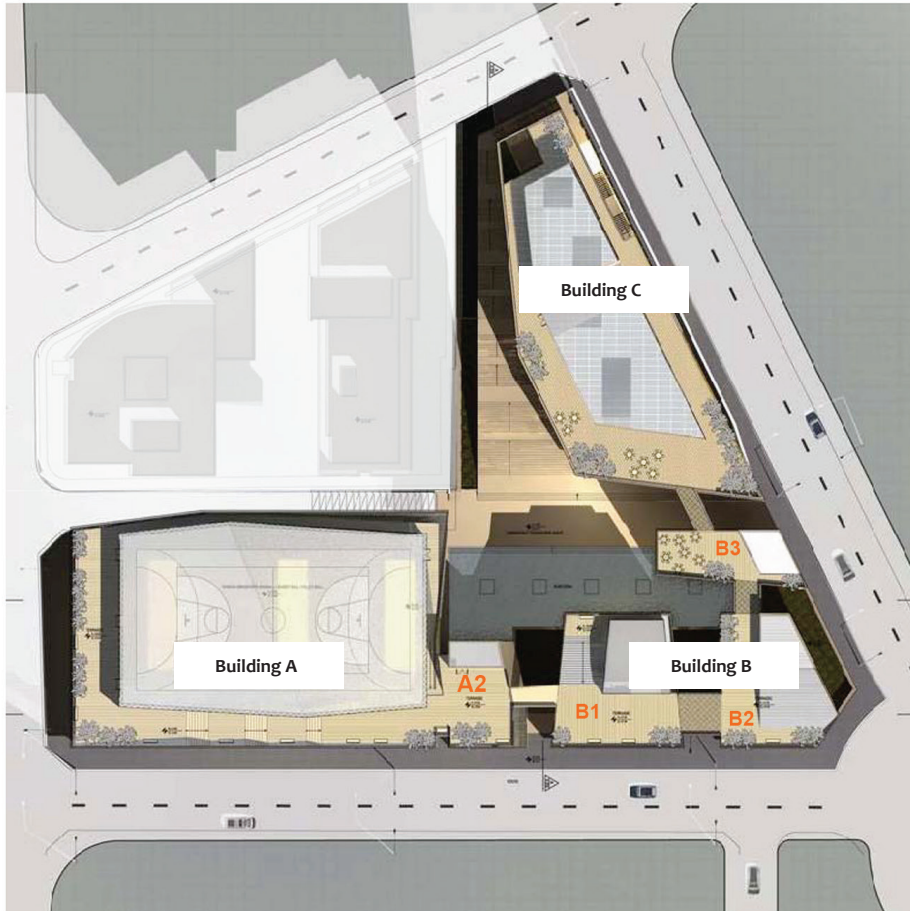

- Building A:**
- MIM Museum
 - Laboratory of Biomechanics and Medical Imaging
 - Multi-purpose sports fields
 - Sports Office
 - Sports Center
 - Recherche et Développement SARL
 - PTS billing office

- Building C:**
- Classrooms
 - Saint Joseph Chapel
 - Refectory
 - University Pastoral
 - Innovation and Sports Library
 - FSE
 - PTS Laboratories
 - Cafeteria
 - Employee canteen

- Building B:**
- Saint JosephUSJ Daycare
 - First Aid Room
 - François S. Bassil Auditorium
 - Student Area
 - Campus Administration
 - Michel Ghazal Room
 - IET, IPM, STI, ISO, SPCOM
 - IPM and ISO Care Centers
 - CGGM: Center Jacques Loiselet for Medical Genetics and Genomics
 - Board Room
 - Federation of Alumni Associations
 - Employee Canteen

